

ASSESSOR'S BOOK FOR FRANKLIN TOWNSHIP

KOSCIUSKO COUNTY, INDIANA

1895

(INCLUDING SEVASTOPOL)

Bell Memorial Public Library

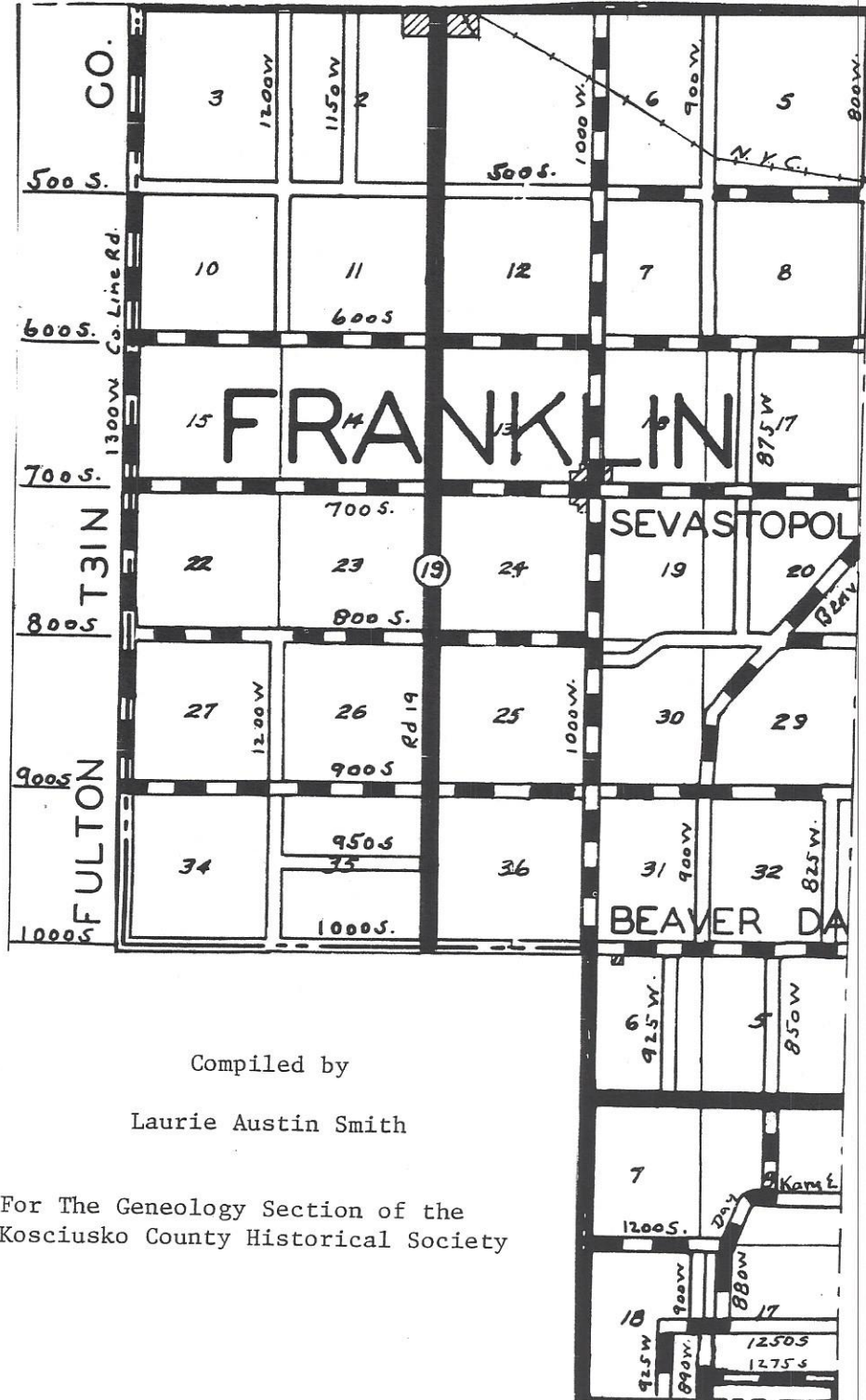

Compiled by

Laurie Austin Smith

For The Geneology Section of the
Kosciusko County Historical Society

ASSESSOR's BOOK for FRANKLIN TOWNSHIP
Kosciusko County, Indiana
1895

NAME	Section	Acres	NAME	Section	Acres
Arnsberger, Solomon	14	200	Borton, C.M.		PP
Antrim, Elizabeth	14	160	Blane, Wm		Poll Tax
Adamson, Benjamin	35	200	Borton, Ira Est		PP
Ault, Benjamin F.	6	40	Blue, A.W.		Poll Tax
Auddell, H. F.	PP		Burns, G.A.		PP
Arnsberger, George	PP		Borton, Wm		Poll Tax
Alexander, J. W.	PP		Bybee, M.M./W.W. (?)		PP
Alexander, Wm	PP		Bidleman, C.R.		PP
Bybee, Hollis C	12	120	Burden, H.		PP
Blue Peter "Abes Son"	18	80	Black, Joseph F.		PP
" " " "	8	160	Bright, Frank		PP
" " " "	17	480	Blue, James Jrn.		PP
" Peter "Bens Son"	2	260	Blue, Alonzo		PP
" Austin	11	110	Blue, John		PP
Black, Henry	8	40	Blue, Bengeman		PP
" James I.	5	160	Borton, Isac		Poll Tax
" John R.	26	320	Blue, John "Guard" for Linden & Addie Blue		PP
" " "	25	170			
" " "	35	147	Catren, Martin	6	2
" " "	30	45	Cook, Samuel K.	27	70
Barnes, Adam	34	120	" " "	26	80
Burket, Simeon	20	103	Clemmer, William	3	160
Barr, Samuel O	34	80	" " "	2	.25
" " "	27	120	Churchill, Levi	7	97
Borton, Lyman	1	100	Cattell, W.H.	15	120
" Allen	1	77	Carpenter, Albert	17	120
" Lineas	11	88	" Alfred	7	1
" "	1	60	Clifton, John W.	26	160
Ballenger, W.W.	34	80	Cuffell, John H.	6	.20
Bright, John	8	80	Cook, John		PP
Blue, James H.	2	44	Cox, Charles		PP
Bybee, Allen	6	226	Churchill, Abner		PP
" "	7	249	Cook, George		PP
Bowen, John A.	18	40	Cook, Alexander		PP
" " "	17	95	Cook, A.J.		PP
Baxter, George H.	3	20	Churchill, C.C.		PP
Burns, Hiram E.	27	10			
Barr, Samuel O.	34	160	Doren, Abraham	5	80
" " "	27	20	" Poindexter	3	35
Burket, Samuel E & Ellen J.	20	17	Dunlap, William	18	.70
Burns, Jonathan	35	40	Decker, Mary	32	40
Ball, John	PP		Day, Jacob E.	18	37
Black, Wm.	PP		" " "	7	16
Barr, Esqr. (?)	PP		" John E.	8	40
Balenger, E.	PP		" Abijah	18	46
Bybee, Elmer	PP		Doren, James	5	16
Black, A.E.	PP		Dulaney, Joy Ann	2	.25

Day, Kary E.	18	40	Henby, W.B.	17	185
" Frank A.	18	50	Harsh, David	3	66
" William B.	17	80	Highway, Benjamin	10	70
Doran, Amos L.	5	41	Holloway, Elizabeth	13	.20
" Cary	5	84	Hawk, Aaron	29	3
" Sarah C.	5	41	Harding, Emeline	12	300
Dunnuck, George	PP		Higgins, Thomas	8	20
Decker, Wm R.	PP		Huffer, Charles D.	7	80
Dickey, G. W.	PP		Hire, Milton E.	24	77
Dunlap, Loyd	PP		Hohnes, Aaron	8	20
Eiler, W.H.	8	120	Harding, O.A.	PP	
Emmons, E.H.	11	80	Huffer, Lawrence	PP	
" " "	1	.20	Huffer, Shurman	PP	
Engle, George	32	40	Herald, E.C.	Poll Tax	
Eaton, Thomas	24	1	Herald, Elmer E.	Poll Tax	
" James & L. J.	32	79	Hosman, E.M.	PP	
Engle, Louisa E.	6	1	Herald, J.W.	PP	
Eiler, Samuel S.	PP		Hipsman, W.C.	PP	
Eaton, John E.	PP		Hall, O. M./W. ?	PP	
Engal, George Jun	Poll Tax		Hall, M/W. E.	PP	
Engel, John	PP		Hart, Daniel	PP	
Engal, David	PP		Herald, D.S.	PP	
Eaton, Isaac	PP		Hartman, Harman	PP	
Emmonds, Henry	PP		Hoppus, Norman R.	PP	
Engal, Rudolph	PP		Holloway, George	PP	
Engal, Pearce	Poll Tax		Holaway, David	PP	
Emmonds, Ephram	PP		Holderman, Cyrus	Poll Tax	
Fawley, George W.	1	.75	Hire, Alen	PP	
Ford, Calvin	PP		Hire, Harman L.	PP	
Ford, Mary	PP		Igo, Omer	PP	
Good, Jacob	29	1	Johnson, David	32	80
Goshert, Lewis G.	5	55	Jeffries, David	13	160
Griffis, Henry H.	2	2	" Andrew	11	80
Griffen, James B.	2	2	" Ruel	13	80
Garrison, W.D.	1	.60	" William	13	80
Gushert, A.E.	PP		" Levi P.	13	80
Griffis, Marion	PP		(above crossed out and John C Smith written in small with pencil)		
Hart, Fremont	6	40	Judd, Thomas R.	35	120
Hohnes, Clinton	8	40	" " "	34	80
Hall, Darius	11	50	" Allen	26	80
" "	14	120	Jennings, Isaac N.	10	160
" "	1	37	Johnson, Rhesa R.	2	.20
Herald, George W.	5	80	Jones, Chas. B.	3	49
Hire, Rudolph	19	249	Jenkins, David	PP	
" "	20	40	Jones, T. E.	Poll Tax	
" Isaac	20	80	Jenkins, L. D. (crossed out)		
" Milton E.	18	288	Jackson, William (crossed out)		
Holterman, Samuel	36	50	Krouse, Fred	36	60
Hibschman, Jacob	22	24	Kreighbaum, William	24	90
Hosman, Louiza L.	8	20	Kuhn, John	36	60
Harrold, Francis	18	80	Kreighbaum, George	25	50
Harsh, Samuel	3	58	Keesecker, Lugarda	18	.05
Haman, John	6	2	Kreakbaum, John	13	.80
Horne, Washington	15	40	Kerschner, Lucinda	32	1
Harsh, Adam	5	53			

Kreabaum, Isac	PP		
Kreckbaum, Daniel	PP		
Kurn, Jacob	PP		
Krause, Lewis	PP		
Kesler, Jacob	PP		
Kay, Marion	PP		
Kern, Jacob W.	PP		
Long, William	29	60	
Leach, John M.	27	140	
Loyd, John M.	7	161	
" " "	13	40	
Latimore, Marion M.	5	153	
" " "	8	80	
" " "	6	18	
Leininger, Elias	36	69	
Lyons, Wm	1	172	
Lukens, Emma R.	8	40	
Lukins, Add S.	PP		
Landen, Kabpea	PP		
Liter, John	PP		
Lewis, Ephraim (crossed out)			
Myers, Geo. W. "Etal"	1	.60	
Meredith, John C.	6	115	
" " "	35	52	
Manwarring, Loren D.	6	80	
Mollenhour, Elizabeth "Etal"	18	20	
" Lyman L.	18	24	
" " "	13	.94	
Miller, H. F.	25	80	
" Owen F.	25	31	
Manwarring, Elliott	6	124	
Meredith, Henry L.	8	80	
" William	6	80	
McClannehan, Thos J.	8	100	
Meredith, Isaac J.	10	90	
Moon, W. N.	36	80	
Meredith, John G.	3	122	
Mattix, Andrew	5	60	
Morgan, William	11	63	
McFarland, James	32	40	
Mullenhour, John H.	18	.40	
Meyers, Barbary A.	6	1	
" " "	5	40	
Mentzer, Samuel	1	.18	
Morgan, Humphrey L.	2	.20	
Mowry, Nerva & Harriet A.	5	30	
Mulenhour, Norman	Poll Tax		
Mulenhour, Hiram	PP		
Mcfarland, Joseph	PP		
Mcfarland, George	PP		
Meredith, Elisabeth (written in pencil - listed by James W. Blue -)			
Morgan, Hiram (crossed out)			
Molenhour, Norman (crossed out)			
Nelson, William	22	160	
" John	11	80	

Nelson, Thomas	10	55	
Nelson, Mariah - Admr'x Est of William Nelson	PP		
Petry, David	31	44	
" Jacob	31	60	
" "	6	170	
Perry, Nancy Jane	34	9	
" " "	35	26	
Peoples Loan & Savings	32	37	
Parks, Beulah			
Petery, Charles	PP		
Petery, Jacob - Guard for	John Petry		
Rickell, Samuel	29	75	
Rogers, Caleb	34	31	
" "	35	54	
Rice, William	27	160	
Roberts, Nelson	32	40	
Rickell, George W.	24	140	
" Henry H.	25	80	
" William	29	66	
Rogers, James H.	34	40	
R.R. N.Y.C. & St. L.	1	.25	
Rynearson, Frank	2	.20	
Rickell, Winchester	PP		
Riley, Theodore J.	PP		
Rickel, & Fasig	PP		
Sarber, John E.	2	43	
Study, Henry	30	40	
" "	29	40	
Sarber, William	29	40	
Swihart, Mary J.	5	93	
Shoemaker, George W.	5	39	
Strong, Ely	18	45	
Strong, Minerva	18	45	
Smith, John C.	12	180	
" Cleanthes M.	12	40	
Swick, Henry	32	80	
Sarber, Albert	2	120	
Secore, Isaac	7	3	
Stoner, Fletcher	25	160	
" "	31	154	
" "	25	38	
Smith, Andrew J.	14	40	
Strong, W. O.	18	60	
Summer, Samuel	5	60	
Study, Mary	20	80	
Smith, George W.	14	120	
Swick, John F.	3	110	
Smally, Mary	8	80	
Study, Henry E.	30	40	
" " "	29	85	
" Alpheus	31	30	
Snyder, Solomon, Hattey, Mary Ann & Sarah Eliz Moore	17	40	
Shoemaker, Isaac M.	5	80	

Strong, Chas B.	18	60
Summe, Amos	29	30
Stamate, Jacob W.	1	.32
Smith, John C.	13	120
Summe, Lenord	PP	
Swihart, Edward	PP	
Swihart, Ananias	PP	
Study, Fernando	PP	
Smith, Ephraim	PP	
Shivley, Wm	PP	
Smith, Aaron	PP	
Sarber, C.	Poll Tax	
Smith, Wm O.	PP	
Smith, B(ro)?	PP	
Shotis, Bengeman	PP	
Sume, Alfred	PP	
Tucker, Horace	19	160
" "	20	318
" "	29	170
" "	30	120
" Hollis C.	32	203
" Albert L.	31	218
" " "	27	80
Teel, David	15	160
Tucker, Horace & Albert	30	84
" Albert	1	176
" "	15	280
" "	24	180
" "	22	456
" "	23	640
Teal, Alfred	15	40
" "	10	25
" Alfred & Lugarda	10	40
Townsend, Thomas D.	3	40
Terry, Samuel S.	36	320
Townsend, Anna	10	40
Teel, Clement L.	10	40
" Theadore	10	40
Terry, Daniel E.	29	70
Thomburg, Mariah	2	3
Tucker, Charles M	PP	
Tucker, Norman	Poll Tax	
Utter, Milton H & David J	7	160
" Edwin A.	6	40
" David	PP	
Vandermark, Lovina	13	77
" John H.	13	76
Vandorn, Hiram M.	8	40
Vicory, Charles	PP	
Wiley, Thomas M.	5	109
Widner, Aaron	5	20
Warren, James	19	45
" "	30	5
" "	24	40

Weirick, Jacob	17	160
" "	18	80
" Amanda	8	160
Warren, W.W.	30	125
" " "	24	40
Whittenberger, Daniel	7	117
" Alvin S.	7	40
Webster, James A.	2	160
" " "	11	80
" " "	10	80
Warren, James M.	19	44
" " "	24	70
" " "	25	30
" " "	27	40
Whittenberger, Daniel & Laura B. Vickery	8	80
Wertenberger, Ira B.	6	70
Wiley, Cynthia H. & Mary A. Dent	5	53
Warren, David & Robert E	1	.50
White, Charles F.	34	20
" Florence E.	34	20
Warren, Elmer	Poll Tax	
Wilson, Isac	PP	
Webster, Charles	PP	
White, George	PP	
Warren, James S.	PP	
Whetstone, Wm H.	PP	
Whetstone, Thomas	PP	
Warren, Isaac E.	PP	
Warren, Charles W.	PP	
Whetstone, Abram	PP	
Wertenberger, L. S.	PP	
Wiley, Cynthia A. - Admr'x Est Mary A. Dent (crossed out)		
Warren, David	PP	
Yeagle, Mathew	7	80
Yocum, Elmore	8	80
Young, C. L.	17	40
" Jacob	17	41
" Francis M.	17	40

SEVASTOPOL

Burns, Abner C.	Mullenhour, John H.
" Jesse D.	McFarland, Mary A.
Eaton, Thomas	Morgan, Hiram & Lottie
" Levi H.	
Eaton & Vandermark	Reiner, Clark
Holloway, Elizabeth	Rannels, W. S.
Jackson, William	Towl, Amos
Julian, Anna	Tucker & Blue
Jenkins, Lorenzo B.	Vandermark, John H.
Keesecker, Lugarda	
Lewis, Ephraim	